



CAERLEON CONSERVATION AREA 2019 BOUNDARY AMENDMENTS

REVIEWING THE BOUNDARY

The Caerleon Conservation Area boundary was extended in 1977, the only time it had previously been amended since its original designation in 1970. Best practice prescribes that Conservation Area boundaries are occasionally reviewed to ensure that the original reasons for designation are still relevant and evident. It is recognised that boundaries were historically drawn too tightly or illogically, and it may therefore be appropriate to amend them. A review of the boundary, as well as any accompanying guidance and assessment, should generally take place every five years or in response to notable change, including changes in policy or legislation.

The adopted amendments to the boundary in 2019 are:

- A** The removal of two buildings in the north corner.
Reason: These do not reflect the character of the Conservation Area.
- B** The addition of Brodawel House and its grounds.
Reason: In recognition of the contribution the boundary wall and character of the house makes to the Conservation Area.
- C** The addition of a group of buildings on the north side of Mill Street.
Reason: In recognition of their contribution to the streetscape and continuation of characteristic features.
- D** Minor reconfiguration of the boundary near Hanbury Close.
Reason: To rationalise the boundary in line with plot boundaries.
- E** Minor reconfiguration of the boundary off Bulmore Road.
Reason: To rationalise the boundary in line with plot boundaries.

The removal of the open fields between the river and amphitheatre was also considered as this area is better protected under Scheduled Monument legislation. However, consultation responses indicated a strong preference for it to be retained as part of the Conservation Area.

Mae'r Cyngor yn croesawu gohebiaeth yn Gymraeg, Saesneg, yn y ddwy iaith, neu ieithoedd a fformatau eraill. Byddwn yn cyfathrebu a chi yn ol eich dewis. Ni fydd gohabu yn Gymraeg yn arwain at oedi.

The Council welcome correspondence in English, Welsh both languages or other languages and formats. We will respond to you according to your preference. Corresponding in Welsh will not lead to delay.

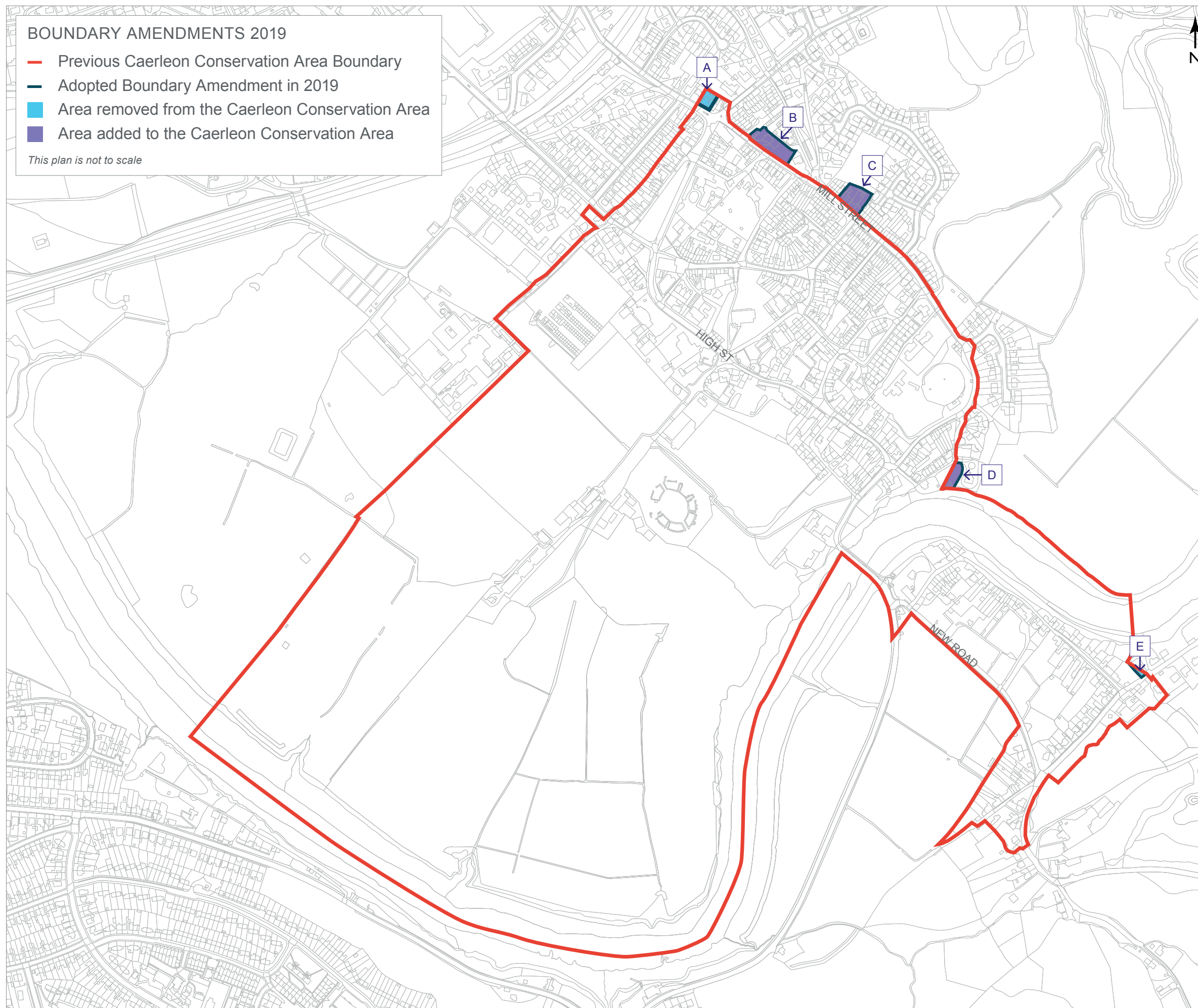

[THIS PAGE HAS INTENTIONALLY BEEN LEFT BLANK]

[THIS PAGE HAS INTENTIONALLY BEEN LEFT BLANK]

